

# PLA Performed Loop

## For Access Control

The RENO PLA Performed Loop is a prefabricated loop / lead-in assembly designed to be installed in a 1/8" (0.32 cm) saw cut or wider. The PLA is designed to maximize durability and maintain a flexible form that is easy to install and handle. All wire insulation is constructed with the optimal thickness of Cross-linked Polyethylene (XLPE) necessary to ensure a long, trouble free life. XLPE insulation provides excellent thermal, electrical, and physical properties and is recognized for its outstanding resistance to moisture and chemicals.

### Ordering Information:

Model PLA-XX-XX

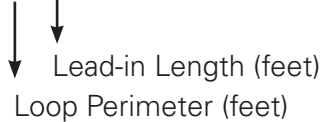

Note: Two extra feet of the four conductor loop cable is added during manufacturing process. The extra cable allows for variations in the saw cut. The extra cable is placed in the lead-in saw cut.

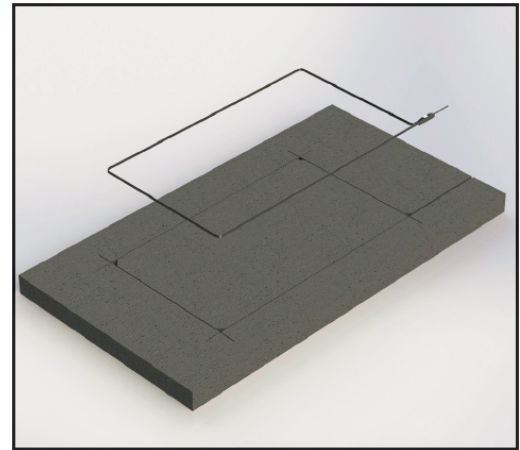

- Installs in 1/8" wide saw cut

- Design ensures an exact fit of the loop in the saw cut

- No need to cut 45° corners

- Wire insulation is Cross-linked Polyethylene (XLPE)

- Loop / Lead-in cables are flexible for easy handling and installation.

- All splice connections are soldered, sealed and tested during fabrication.

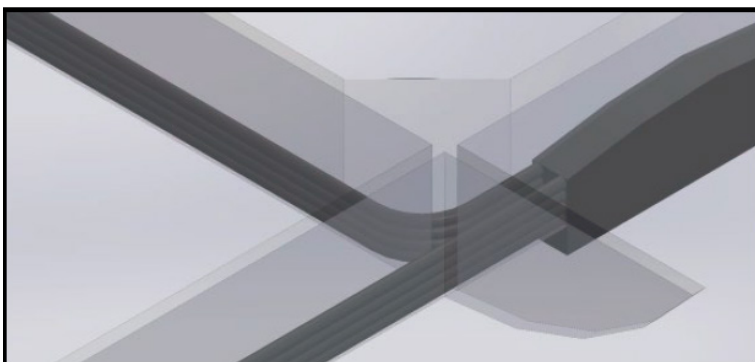

Close up of splice box in 0.25" saw cut.

# PLA Specifications

## Two Conductor Lead-in Cable

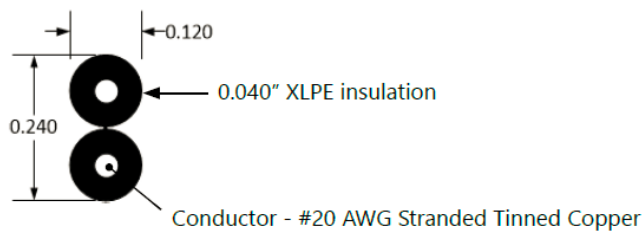

## Four Conductor Loop Cable

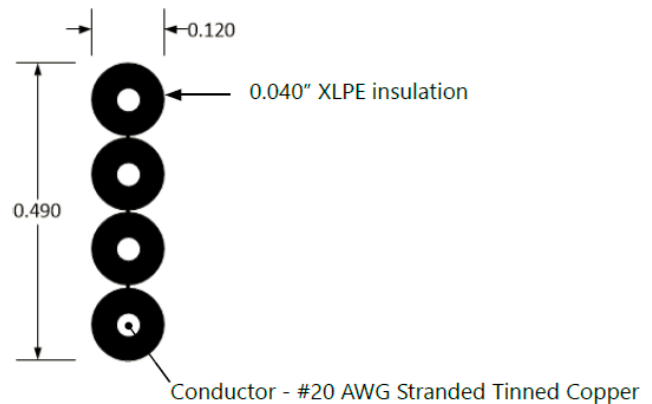

## Installation Methods (see Installation Instructions for details)

Cables are shown as **ORANGE** for clarity.

### 1. Splice joint installed in a 1-inch hole



### 2. Splice joint installed in the lead-in saw cut



## HIGHLIGHTS:

- Saw cut Minimum 1/8" wide 1 1/4" deep
- Remove sharp inside corners at
- Install loop. Extra loop cable will fit in the lead-in saw cut
- Method 1.
  - Mark and drill 1" hole 3" before the splice joint. Widen the lead-in saw cut to 1/4" to accommodate the loop cables. Fill hole with sand to top of the splice joint.
- Method 2.
  - Mark 3" after the splice joint. Widen the lead-in saw cut to 1/4" to accommodate the loop cables
  - Fill the saw cuts with loop sealant